

Bruciatore di gasolio • Light oil burner • Brûleur fioul • Öl-Gebläsebrenner
Quemador de gasóleo

Gulliver RG1RKD COD. **3736651** TIPO / TYPE / TYP **366 T1**

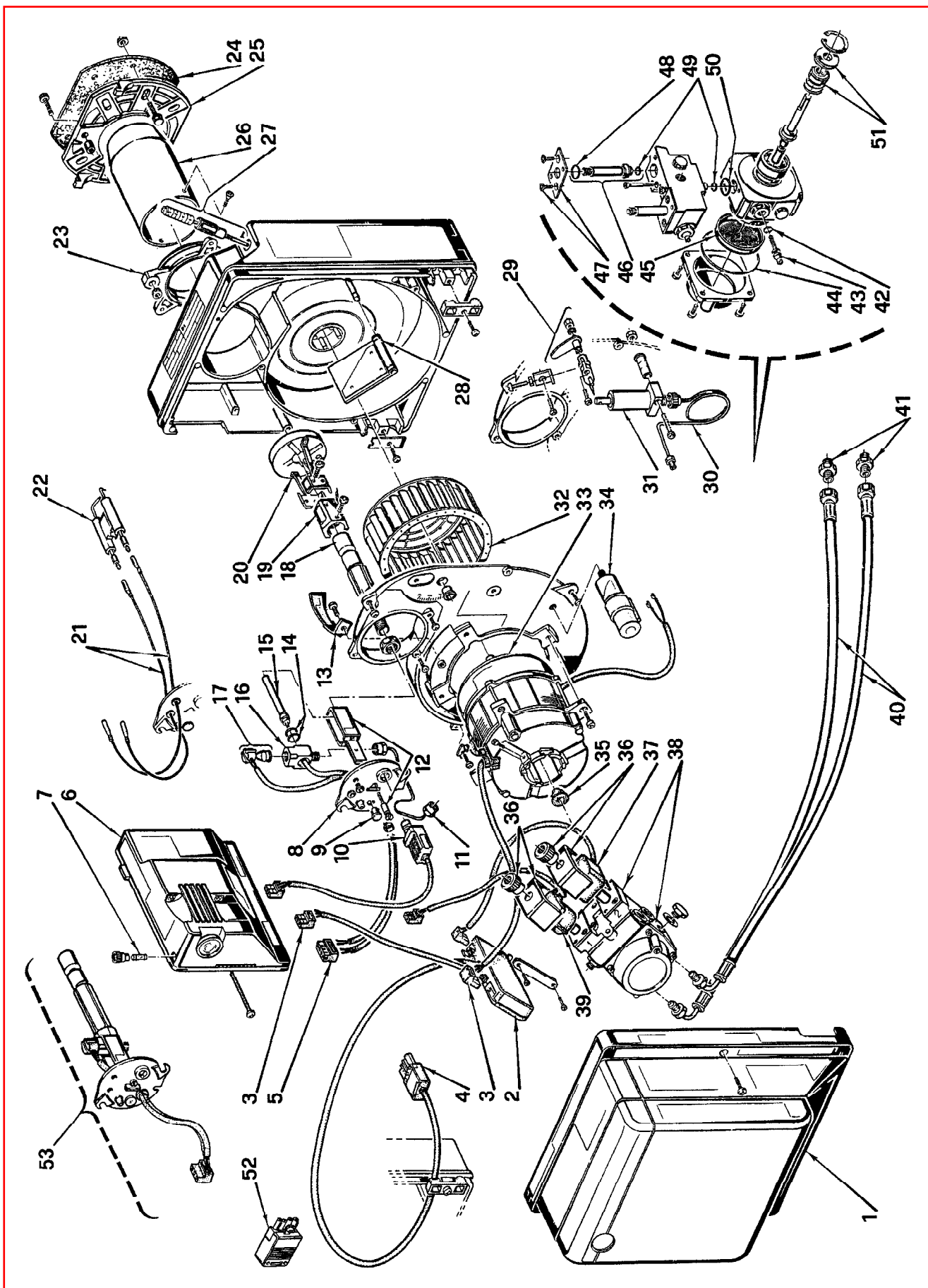

N.	COD.	DESCRIZIONE	DESCRIPTION	DESCRIPTION	BESCHREIBUNG	DENOMINACIÓN
1	3008080	COFANOCOFANO	COVER	CAPOT	BRENNERHAUBE	ENVOLVENTE
2	3008983	RITARDATORE ELETTRONICO	ELEC.START DELAYNG DEVICE	RETARDATEUR ELECTRONIQUE	ELEKTRONISCHER VERZÖGERER	RETARDADOR ELECTRÓNICO
3	3007454	PRESA	SOCKET	PRISE	STECKDOSE	CONECTOR
4	3006949	PRESA A 4 POLI	4 POLE SOCKET	PRISE 4 POLES	4 - POLIGE STECKDOSE	CONECTOR HEMBRA DE 4 CONTAC
5	3007456	PRESA (Termostato/PTC)	SOCKET (Thermostat/PTC)	PRISE (Thermostat/PTC)	STECKDOSE (Vorwärmer/Thermostat)	CONECTOR (Termost. PTC)
6	3001168	APPARECCHIATURA 550SE	CONTROL BOX 550SE	BOITE DE CONTROLE 550SE	STEUERGERÄT 550SE	CAJA DE CONTROL 553SE
7	3007396	FUFUSIBILE	FUSE	FUSIBLE	FEINSICHERUNG	FUSIBLE
8	3007510	COPERCHIO	COVER	COUVERCLE	DÜSENSTOCK-FLANSCH	TAPA
9	3007458	VETRINO	VIEWING PORT	REGARD	VERSCHLUßSTOPFEN	MIRILLA
10	3007492	FOTORESISTENZA	P.E. CELL	CELLULE PHOTORESIST.	FOTOWIDERSTAND	FOTORESISTENCIA
11	3007859	TUBO	TUBE	TUYAU	DRUCKROHR	TUBO
12	3007512	STAFFA E VITE	BRACKET AND SCREW	SUPPORT ET VIS	DÜSENSTOCKHALTERUNG	SOPORTE ARRASTRE Y TORNILLO
13	3007475	CONVOGLIATORE	SUCTION DUCT	CONVOYEUR D'AIR	LUFTLEITBLECH	GUÍA
14	3007172	ANELLO OR	O-RING	JOINT TORIQUE	O-RING-DICHTUNG	JUNTA TÓRICA
15	3007464	RISCALDATORE PTC	HEATER PTC	RECHAUFFEUR PTC	VORWÄRM-PTC-DÜSENSTOCK	RESISTENCIA PTC
16	3007463	RACCORDO	CONNECTOR	MAMELON	HALTERUNG VORWÄRM-THERMOSTAT	RACORD
17	3007462	TERMOSTATO	THERMOSTAT	THERMOSTAT	VORWÄRM-THERMOSTAT	TERMOSTATO
18	3007467	PORTAUGELLO	NOZZLE HOLDER	PORTE GICLEUR	DÜSENSTOCK	PORTABOQUILLA
19	3006276	SUPPORTO TURBOLATORE	DIFFUSER DISC SUPPORT	PORTE ACCROCHEUR-FLAMME	STAUSCHEIBENHALTERUNG	SOPORTE DISCO ESTABILIZADOR
20	3007514	ELICA	DIFFUSER DISC	ACCROCHE FLAMME	STAUSCHEIBE	DISCO ESTABILIZADOR
21	3007465	COLLEGAMENTO A.T.	HIGH VOLTAGE LEAD	CABLE HAUTE TENSION	KABEL ZÜNDELEKTRODEN	CABLES ELECTRODOS
22	3007513	GRUPPO ELETTRODI	ELECTRODE ASSEMBLY	GROUPE ELECTRODES	ELEKTRODENBLOCK	CONJUNTO ELECTRODOS
23	3007515	COLLARE	COLLAR	COLLIER	BRENNERFLANSCH	COLLARÍN
24	3005787	SCHERMO	GASKET	JOINT ISOLANT	KESSELFANSCH-DICHTUNG	JUNTA AISLANTE
25	3008636	FLANGIA	FLANGE	BRIDE	KESSELFANSCH	BRIDA
26	3007516	BOCCAGLIO	BLAST TUBE	GUEULARD	FLAMMROHR	TUBO LLAMA
27	3007517	REG. SERRANDA 2° STADIO	2 nd STAGE AIR DAMPER REG.	REG. VOLET AIR 2 ^{ème} ALLURE	2. ST. LUFTKLAPPENREGLER	CONJUNTO REGUL. REG. 2° ETAPA
28	3007519	SERRANDA ARIA	AIR DAMPER	VOLET D'AIR	LUFTKLAPPE	REGISTRO DEL AIRE
29	3007861	REG. SERRANDA 1° STADIO	1 st STAGE AIR DAMPER REG.	REG. VOLET AIR 1 ^{ère} ALLURE	1. ST. LUFTKLAPPENREGLER	CONJUNTO REGUL. REG. 1° ETAPA
30	3007860	TUBO	TUBE	TUYAU	DRUCKROHR	TUBO
31	3007784	MARTINETTO	HYDRAULIC JACK	VERIN AIR	LUFTKLAPPE DRUCKKOLBEN	HIDRÁULICO DE AIRE
32	3007476	GIRANTE	FAN	TURBINE	GEBLÄSERAD	TURBINA
33	3008489	MOTORE	MOTOR	MOTEUR	MOTOR	MOTOR
34	3007479	CONDENSATORE 4µF	CAPACITOR 4µF	CONDENSATEUR 4µF	KONDENSATOR 4µF	CONDENSADOR 4µF
35	3000443	GIUNTO	JOINT	ACCOUPEMENT	PUMPENKUPPLUNG	ACOPLAMIENTO
36	3006553	MANTELLO E POMELLO	SHELL AND KNOB	ETRIER ET ECROU	HALTEBÜGEL MIT SCHRAUBE	PROTECCIÓN BOBINA
37	3007858	BOBINA 2	COIL 2	BOBINE V. M. 2	MV SPULE 2	BOBINA 2
38	3007854	GRUPPO POMPA-VARIATORE	SPEED GEAR PUMP	POMPE VARIATEUR	GETRIEBE-PUMPE	CONJUNTO BOMBA-VARIADOR
39	3008917	BOBINA 1	COIL 1	BOBINE V. M. 1	MV SPULE 1	BOBINA 1
40	3005720	TUBO FLESSIBILE	FLEXIBLE OIL LINE	FLEXIBLE	ÖLSCHLAUCH	TUBO FLEXIBLE
41	3009068	RACCORDO	CONNECTOR	MAMELON	ANSCHLUßNIPPEL	RACORD
42	3007028	ANELLO OR	O-RING	JOINT TORIQUE	O-RING-DICHTUNG	JUNTA TÓRICA
43	3007202	REGOLATORE	REGULATOR	REGULATEUR	DRUCKREGULIERSCHRAUBE	REGULADOR
44	3007162	ANELLO OR	O - RING	JOINT TORIQUE	O-RING-DICHTUNG	JUNTA TÓRICA
45	3005719	FILTRO	FILTER	FILTRE	FILTEREINSATZ ÖLPUMPE	FILTRO
46	3006925	VALVOLA	NEEDLE VALVE	VANNE MAGNETIQUE	MAGNETVENTIL-KÖRPER	VÁLVULA
47	3007203	PIASTRINA	PLATE	PLAQUETTE ETRIER	PLATTE	PLATINA

